

fiberglass BOX™

ISSUE DATE: 01/07/2026

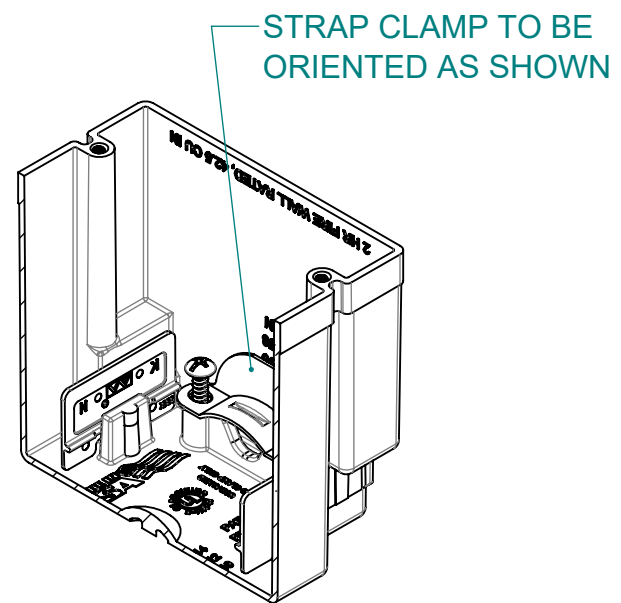
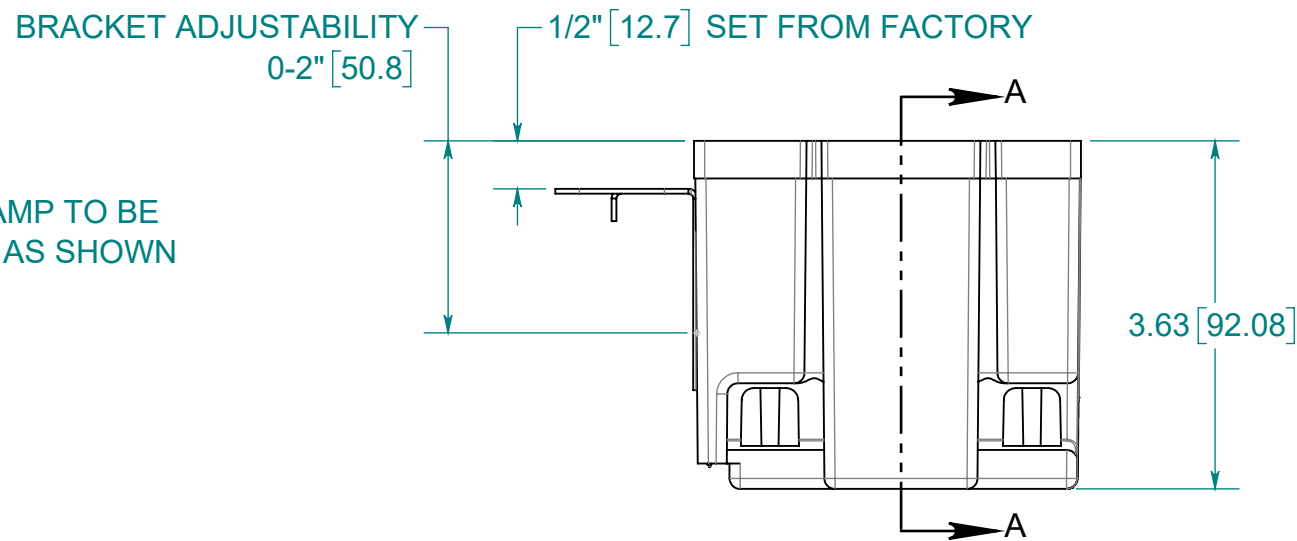
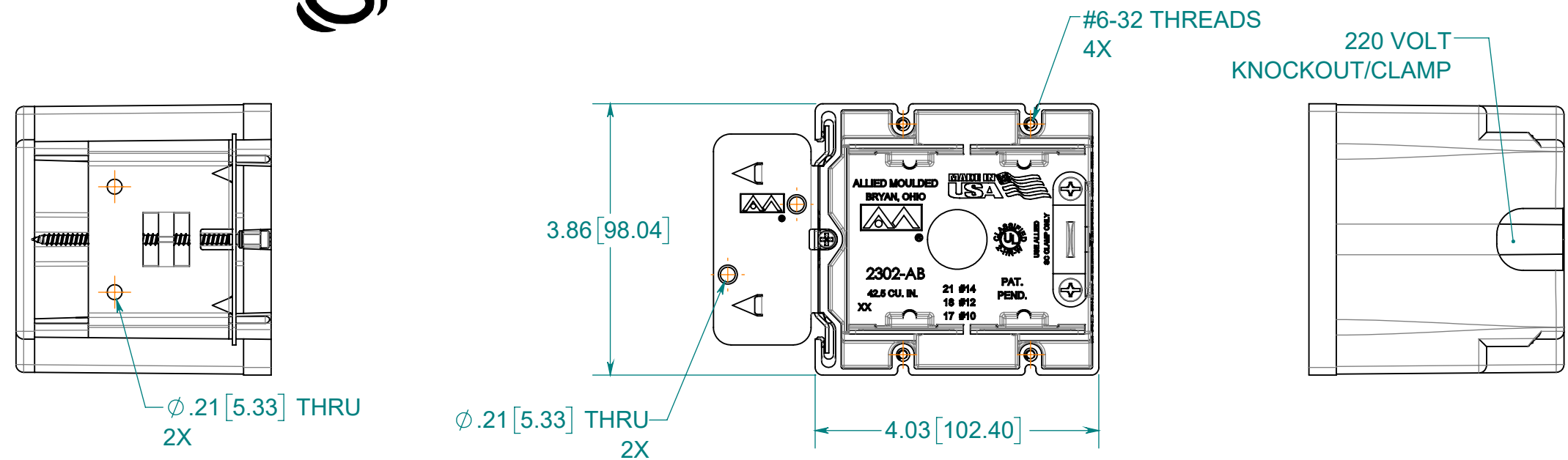

SECTION A-A

- NOTES:**
- MATERIALS:**
BOX: FIBERGLASS REINFORCED POLYESTER
ADJUSTABLE BRACKET: GALVANIZED STEEL
ADJUSTMENT SCREW: ZINC PLATED STEEL
CLAMP STRAP: GALVANIZED STEEL
CLAMP STRAP SCREWS: ZINC PLATED STEEL
SPEED "K" KLAMPS: PVC
 - UL LISTED WITH 2 HOUR FIRE RATING FOR WALL
 - (4) SPEED "K" KLAMPS FACTORY INSTALLED
 - (1) STRAP CLAMP W/ SCREWS FACTORY INSTALLED
 - DIMENSIONS ARE FOR REFERENCE ONLY AND SUBJECT TO CHANGE WITHOUT NOTICE

CONFIDENTIAL
THIS MATERIAL IS OWNED BY THE ALLIED MOULDED PRODUCTS COMPANY, IS DISCLOSED IN CONFIDENCE AND IS NOT TO BE REPRODUCED OR DISTRIBUTED WITHOUT PRIOR WRITTEN PERMISSION FROM ALLIED MOULDED PRODUCTS.
© Allied Moulded Products, Inc.
2018 All Rights Reserved



® **ALLIED MOULDED PRODUCTS**
BRYAN, OHIO

The Original Fiber Glass Outlet Box

PRODUCT SERIES

ADJUSTABLE TWO GANG 42.5 CU IN
W/ "K" KLAMPS AND STRAP CLAMP

Part No.

2302-ABKSC