

Date	Rev	Description	ECN No.	ISSUE DATE	DB	CK	REL
08/27/2019		INITIAL RELEASE	ECN-345		DJL	LJS	GEL
-	-	-	-	-	-	-	-
-	-	-	-	-	-	-	-

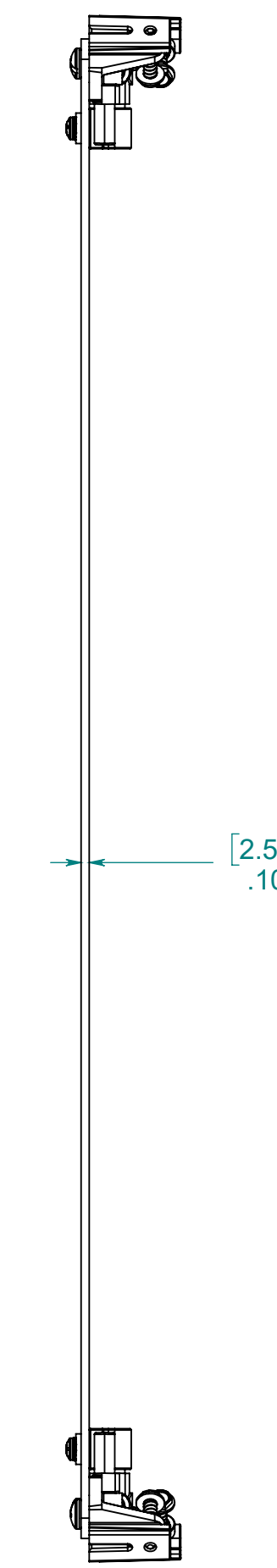

ITEM NO.	PART NUMBER	DESCRIPTION	HFP QTY.
1	70-HFPP2016-1	HINGED FRONT PANEL, POLYLINE 20x16, ALUMINUM	1
2	WPHINGE-HFPP	POLYCARBONATE HFP HINGE	2
3	55-1032516	COMBO PAN HEAD MACHINE SCREW	2
4	70-60431	#6 TYPE A PLAIN WASHER	4
5	70-632	#6-32 HEX MACHINE SCREW NUT	4
6	70-63238	SCREW SEMS 6-32X.375	4
7	70-WPLGSLDR	SLIDER FOR POLYLINE 16 & 18	4

NOTE:
1. DATA SUBJECT TO CHANGE WITHOUT NOTICE.

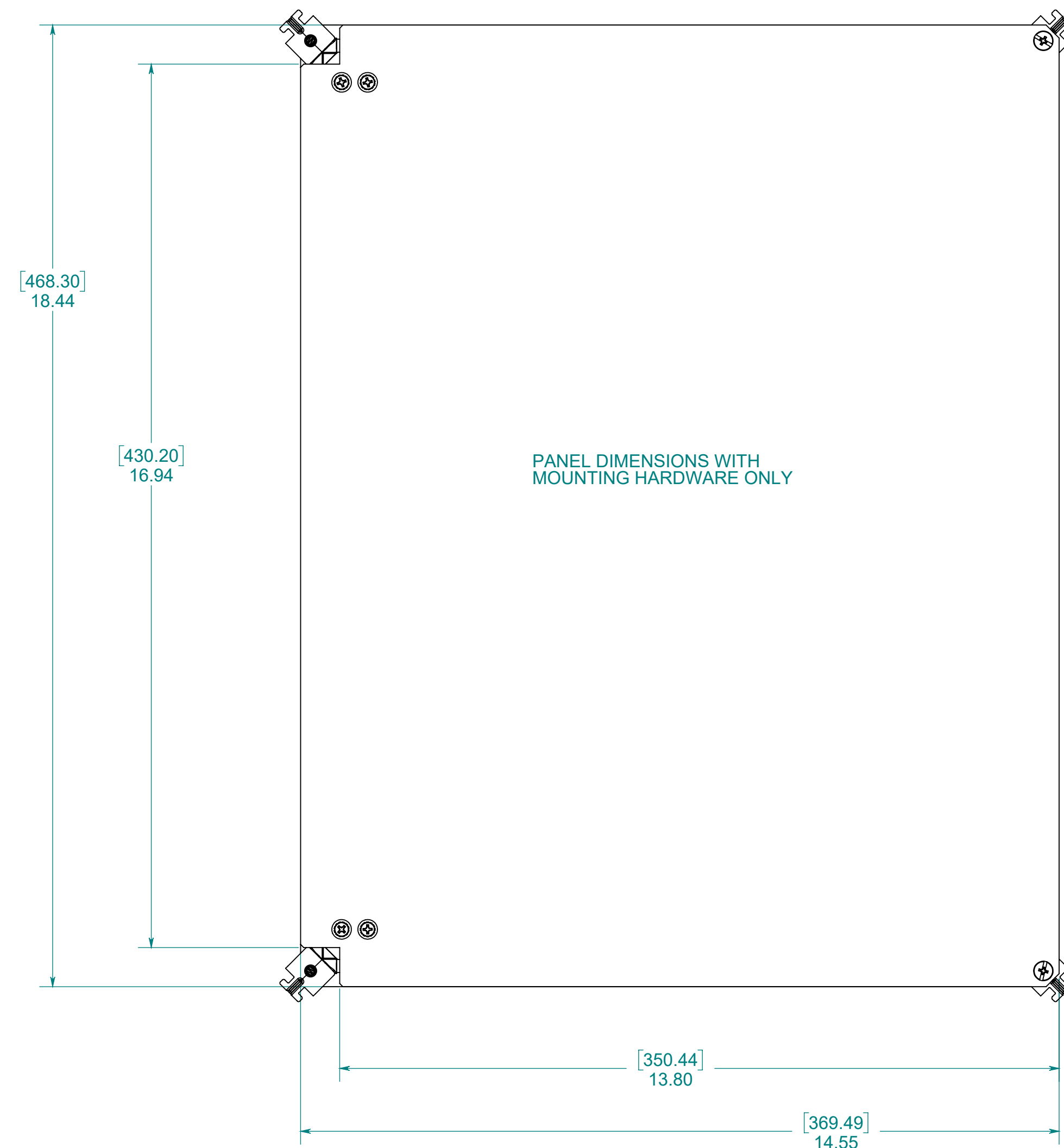
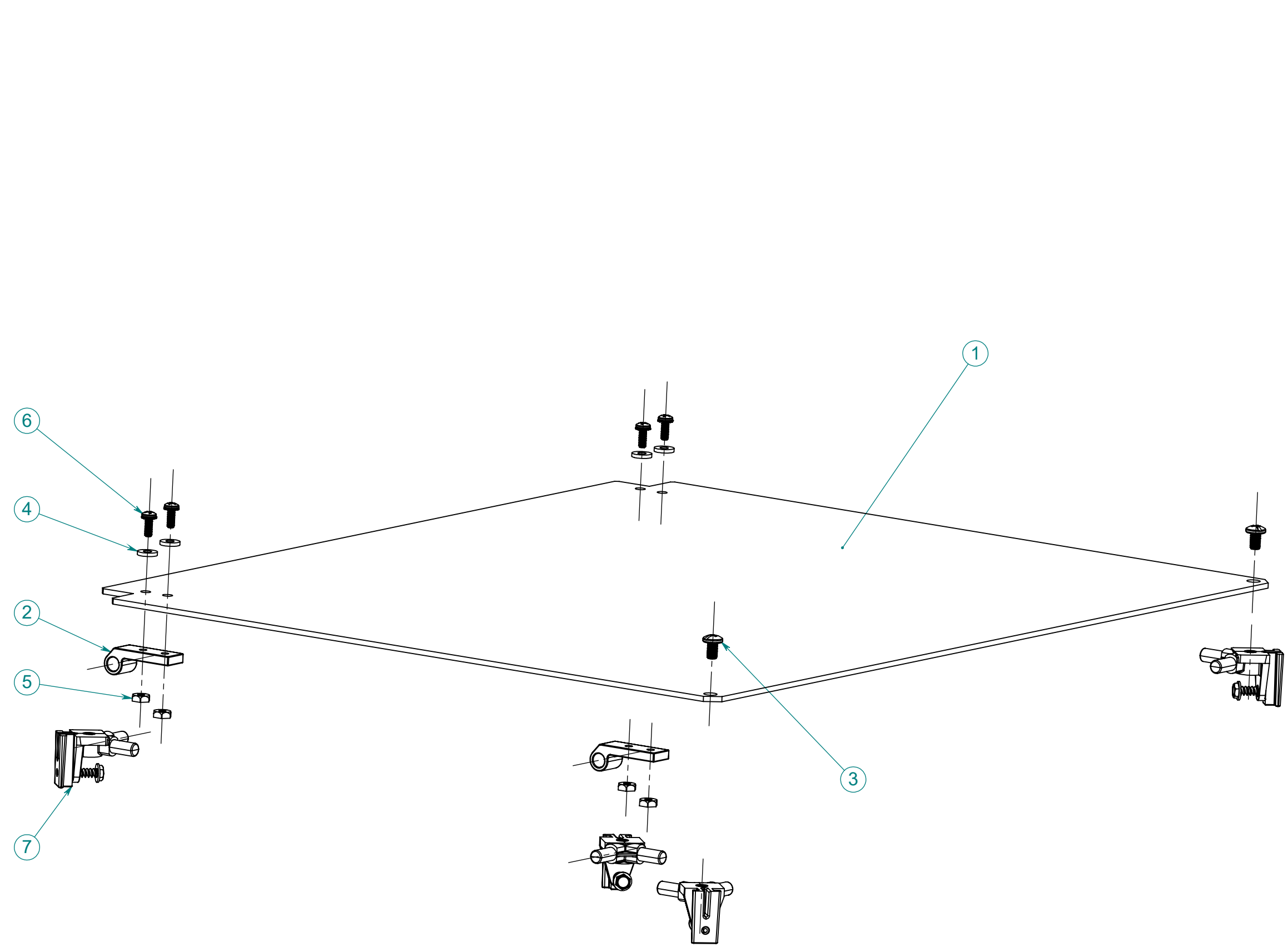
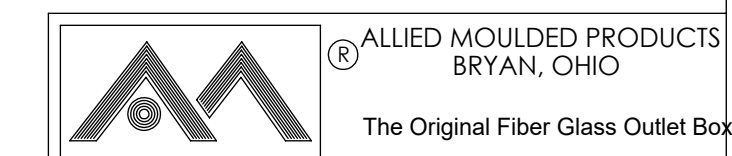
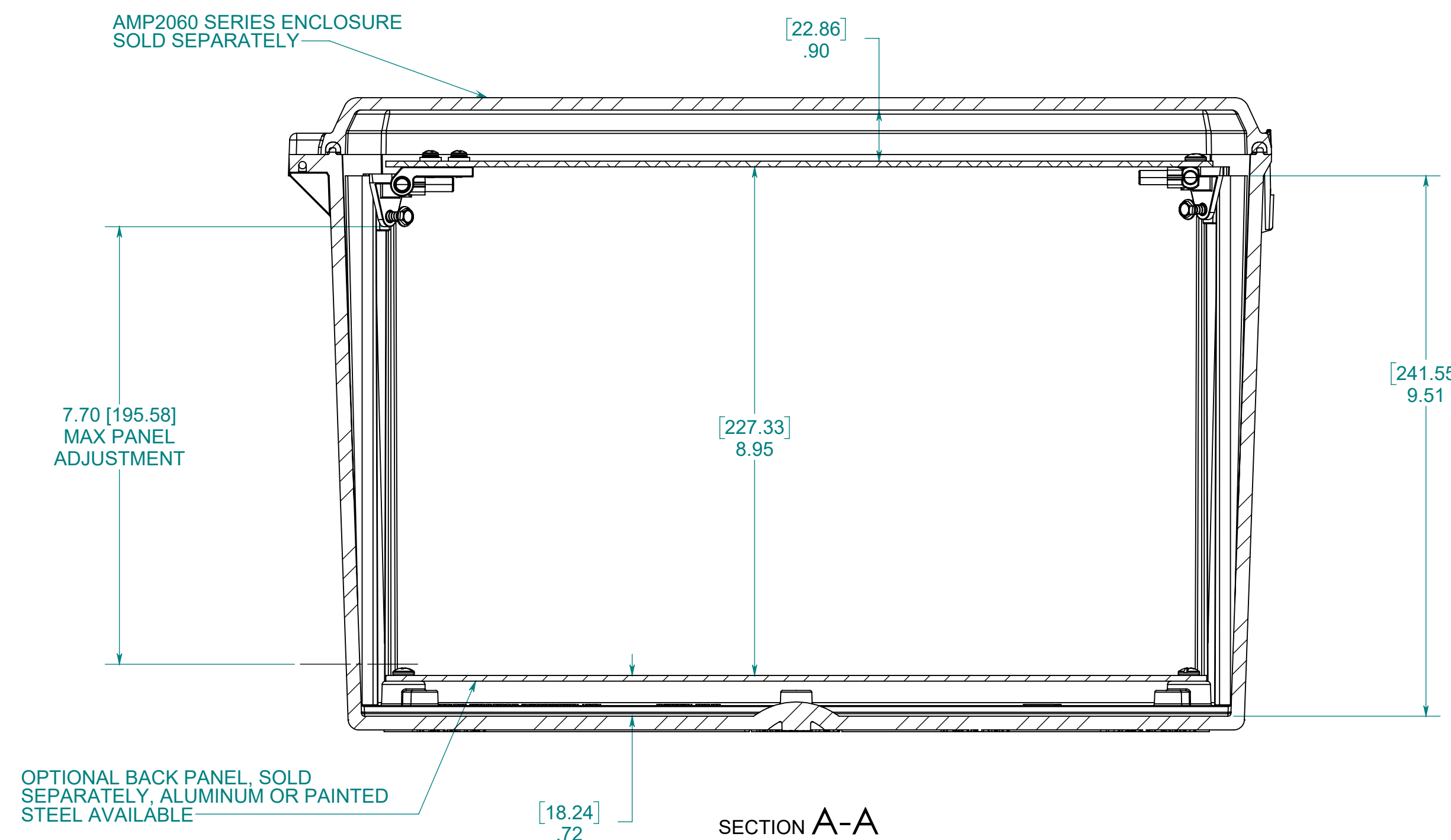

CONFIDENTIAL
THIS MATERIAL IS OWNED BY THE ALLIED MOULDED PRODUCTS COMPANY, IS DISCLOSED IN CONFIDENCE, AND IS NOT TO BE REPRODUCED OR DISTRIBUTED WITHOUT PRIOR WRITTEN PERMISSION FROM ALLIED MOULDED PRODUCTS.
© 2018 Allied Moulded Products, Inc.
All Rights Reserved

Description
AMP Polyline
Part No.
HFPP206